

AUG 05 11:20:04-25 FLEX FILM - ELIZABETHTOWN TJ PATTERSON INDUSTRIAL PARK\_C-101.2 AND 101.3 MASS SITE GRADING PLANNING

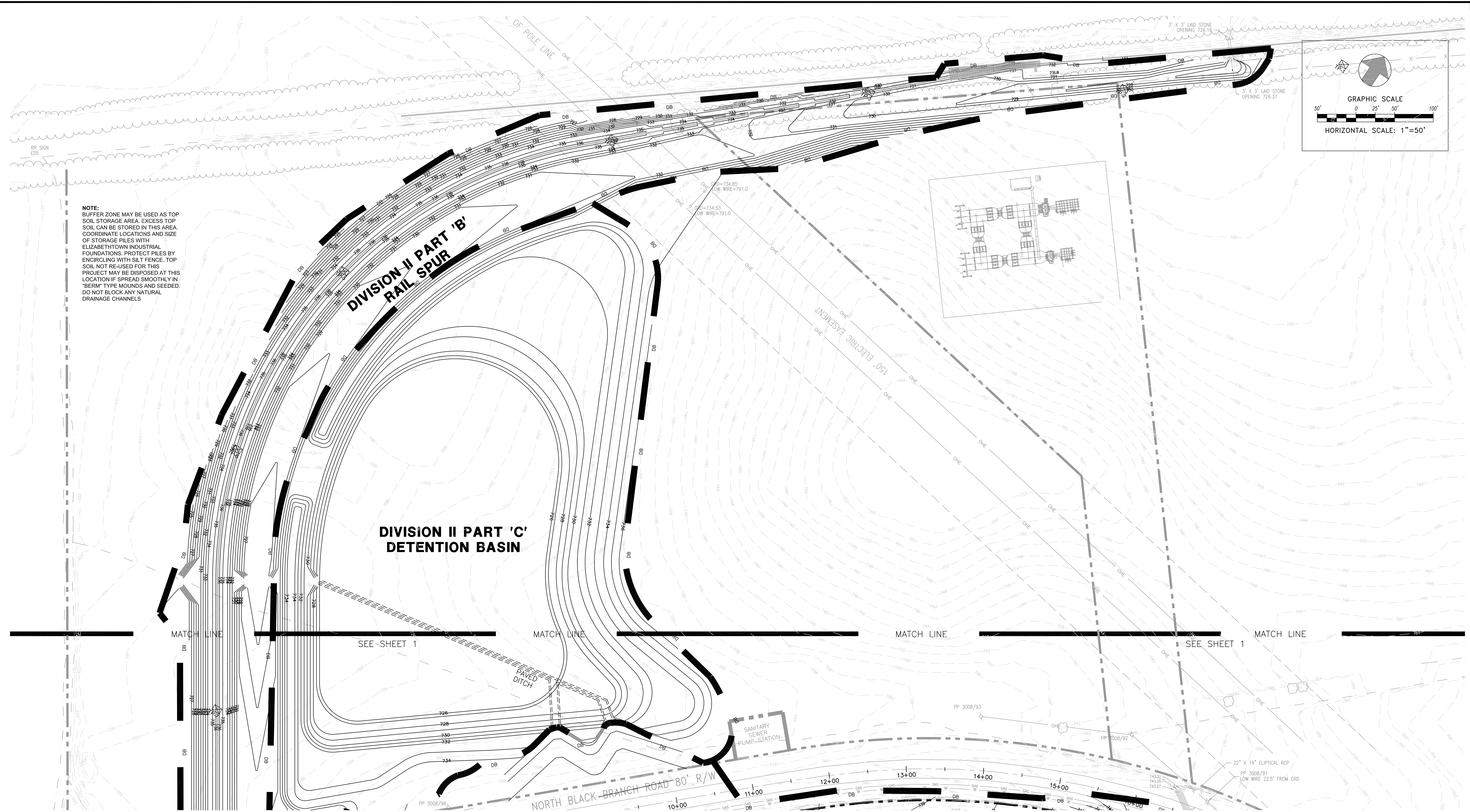

**NOTE:**  
 BUFFER ZONE MAY BE USED AS TOP SOIL STORAGE AREA. EXCESS TOP SOIL CAN BE STORED IN THIS AREA. COORDINATE LOCATIONS AND SIZE OF STORAGE PILES WITH ELIZABETHTOWN INDUSTRIAL FOUNDATIONS. PROTECT PILES BY ENCIRCLING WITH SILT FENCE. TOP SOIL NOT RE-USED FOR THIS PROJECT MAY BE DISPOSED AT THIS LOCATION IF SPREAD SMOOTHLY IN 'BERM' TYPE MOUNDS AND SEEDED. DO NOT BLOCK ANY NATURAL DRAINAGE CHANNELS.

**NOTE:**  
 BLACK BRANCH ROAD TO BE CLOSED DURING CONSTRUCTION (BY OTHERS)

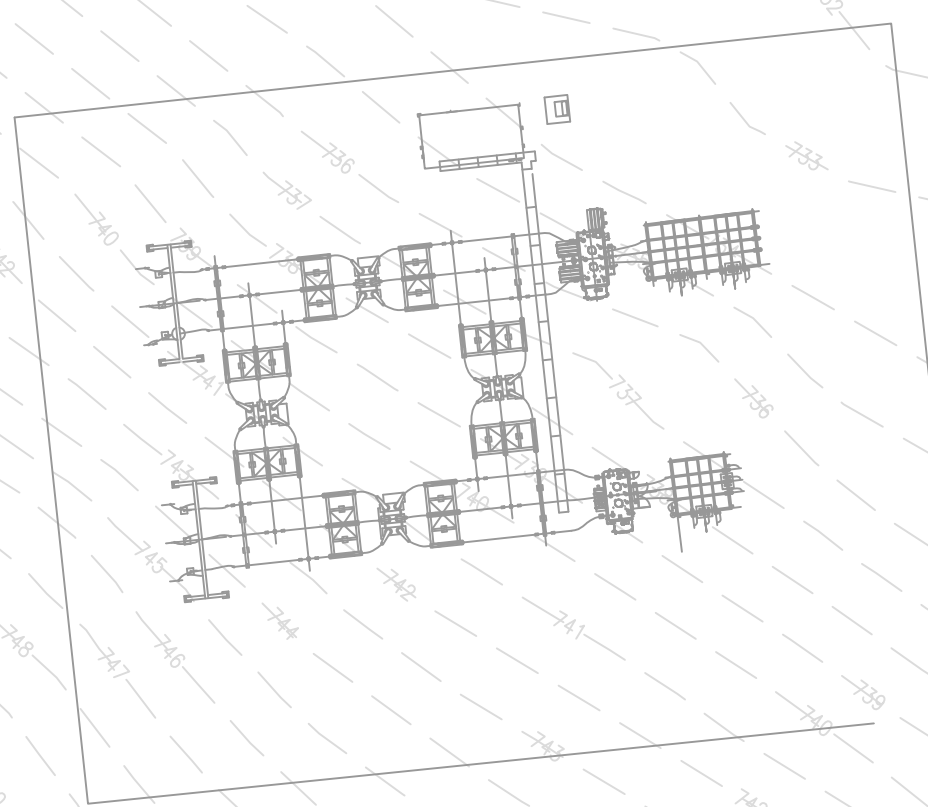
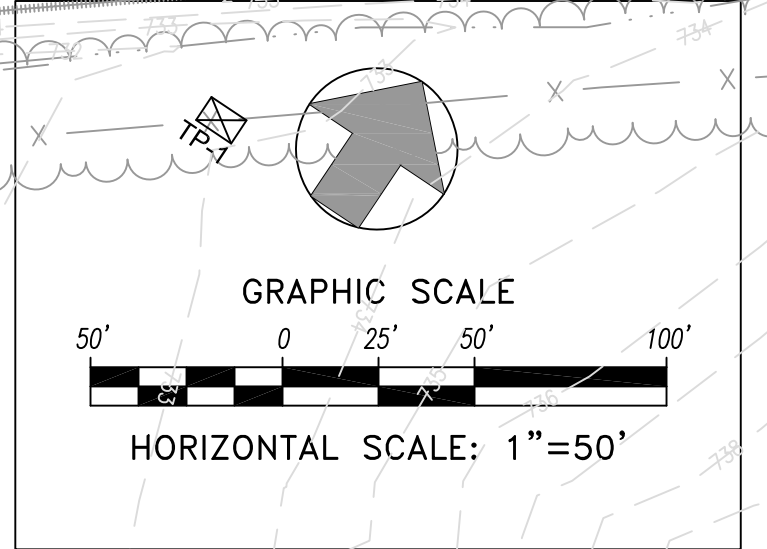

DATE	REVISION	BY

PROJECT NO. 2064-25  
 DESIGNED BY G.A.R.  
 DRAWN BY J.R.M.  
 CHECKED BY G.A.R.  
 REVIEWED BY G.A.R.  
 DATE JUNE 2011  
 SCALE AS SHOWN

**nsc**  
**OF KENTUCKY, INC.**  
 Engineers  
 Architects  
 Planners  
 624 Wellington Way  
 Lexington, KY 40503  
 www.nscinc.com  
 Phone: (859)223-5684  
 Fax: (859)223-2607

**DRAWING NO.**  
**UFL-L12**  
**C-101.3**

**FLEX FILMS (U.S.A.) INC.**  
 1221 NORTH BLACK BRANCH ROAD  
 ELIZABETHTOWN, KENTUCKY 42702  
 PROJECT L-12 BOPET U.S.A.

